

Electric venetian blinds

Barion Plus

Venetian blinds – basic information (3)

Barion Plus 230V (10)

Barion (24)

Dimensions (28)

Installation (32)

Venetian blinds



Venetian blinds

Destination:

- Private apartments
- Hotels
- Offices (perforated blinds)

Design



Venetian blinds

Electric

Classic

Barion
Plus 230V

Barion

Venetian blinds

While estimate the length of blinds, a configuration of furniture and decorating articles in the room should be taken into account.

Obstacles on the way of blind movement should be avoided.

Venetian blinds

Colors venetian blinds made of:

- aluminum
- wood
- bamboo

are available on the website www.miodecor.pl and in a blind sampler in MioBox.

Bamboo:



Wood:



Aluminum:

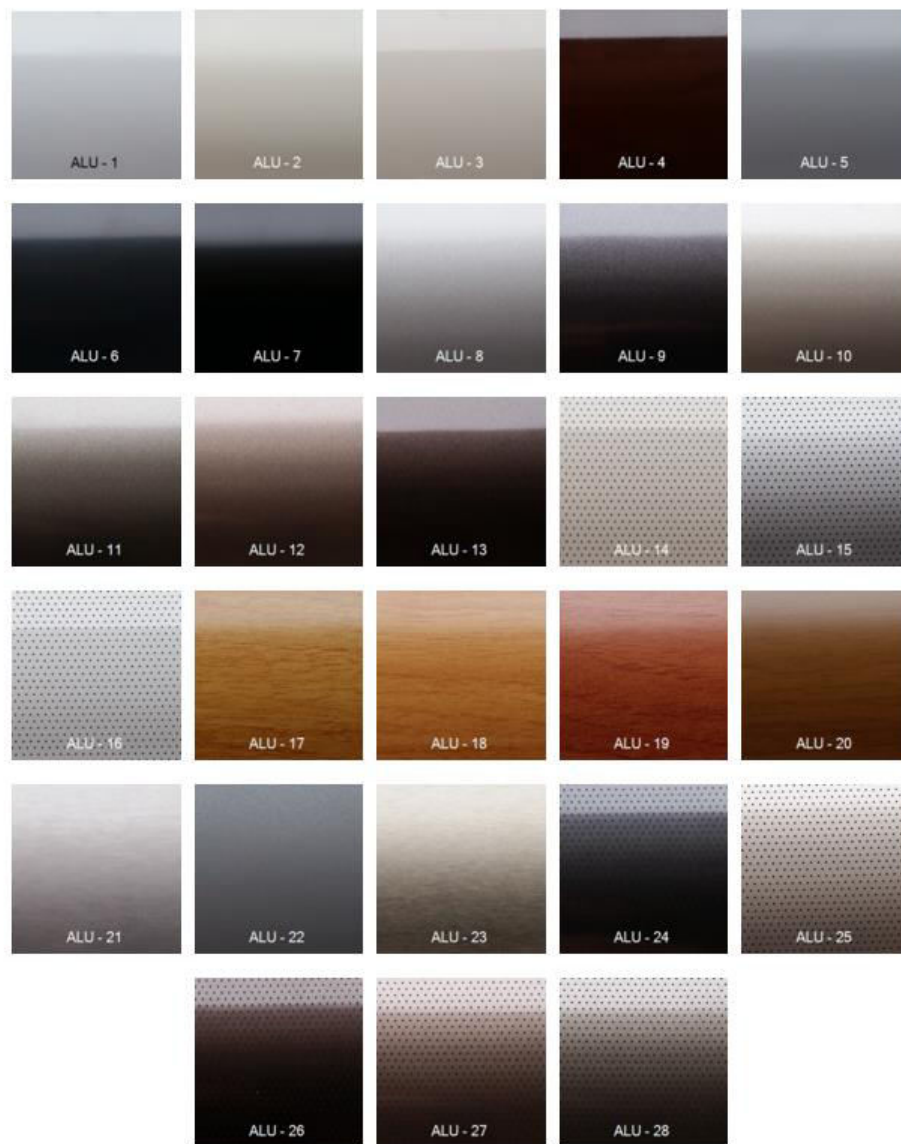



Masking profile

It is possible to make blinds with masking wooden profile. Masking is available in a straight or overlap to sides type.

Masking profile color is the same as wooden of blinds. For aluminum blinds masking profile is in a similar color.



Electric venetian blinds

Barion Plus 230V

Barion Plus 230V

Main characteristics:

- width: 60mm,
- height: 50 mm,
- colors: white,
silver,
bronze,
beige,
black.

Barion Plus 230V

Operating limitations :

- Min width **0,65m.**
- Max width **3,00m.**
- Max height **3,00m.**
- Maximum towing capacity is based on atorque – motors selection table.

Motors selection – Aluminum

[illegible]

Motors selection – wooden/bambo

	100	120	140	160	180	200	220	240
100	3 Nm 30 rpm	3 Nm 30 rpm	3 Nm 30 rpm	3 Nm 30 rpm	3 Nm 30 rpm	3 Nm 30 rpm	3 Nm 30 rpm	3 Nm 30 rpm
120	3 Nm 30 rpm	3 Nm 30 rpm	3 Nm 30 rpm	3 Nm 30 rpm	3 Nm 30 rpm	3 Nm 30 rpm	3 Nm 30 rpm	6 Nm 20 rpm
140	3 Nm 30 rpm	3 Nm 30 rpm	3 Nm 30 rpm	3 Nm 30 rpm	6 Nm 20 rpm	6 Nm 20 rpm	6 Nm 20 rpm	6 Nm 20 rpm
160	3 Nm 30 rpm	3 Nm 30 rpm	3 Nm 30 rpm	6 Nm 20 rpm	6 Nm 20 rpm	6 Nm 20 rpm	6 Nm 20 rpm	6 Nm 20 rpm
180	3 Nm 30 rpm	3 Nm 30 rpm	6 Nm 20 rpm	6 Nm 20 rpm	6 Nm 20 rpm	6 Nm 20 rpm	6 Nm 20 rpm	6 Nm 20 rpm
200	3 Nm 30 rpm	3 Nm 30 rpm	6 Nm 20 rpm	6 Nm 20 rpm	6 Nm 20 rpm	6 Nm 20 rpm	6 Nm 20 rpm	6 Nm 20 rpm
220	3 Nm 30 rpm	3 Nm 30 rpm	6 Nm 20 rpm	6 Nm 20 rpm	6 Nm 20 rpm	6 Nm 20 rpm	6 Nm 20 rpm	9 Nm 12 rpm
240	3 Nm 30 rpm	6 Nm 20 rpm	6 Nm 20 rpm	6 Nm 20 rpm	6 Nm 20 rpm	6 Nm 20 rpm	9 Nm 12 rpm	9 Nm 12 rpm
260	6 Nm 20 rpm	6 Nm 20 rpm	6 Nm 20 rpm	6 Nm 20 rpm	6 Nm 20 rpm	9 Nm 12 rpm	9 Nm 12 rpm	9 Nm 12 rpm
280	6 Nm 20 rpm	6 Nm 20 rpm	6 Nm 20 rpm	6 Nm 20 rpm	9 Nm 12 rpm	9 Nm 12 rpm	9 Nm 12 rpm	9 Nm 12 rpm
300	6 Nm 20 rpm	6 Nm 20 rpm	6 Nm 20 rpm	6 Nm 20 rpm	9 Nm 12 rpm	9 Nm 12 rpm	9 Nm 12 rpm	9 Nm 12 rpm

3 Nm
30 rpm

6 Nm
20 rpm

9 Nm
12 rpm

Barion Plus 230V - mount



Control 230V

Motor PA – three-wire cable (2 control wire)

Motor RTS – two-wire cable (radio control)

- wire control 230V (PA),
- radio control Somfy (RTS),
- smart home systems (PA)

Control 230V

- Motor PA:

Black – phase I

Bronze – phase II

Blue – neutral

- Motor RTS:

Bronze – phase II

Blue – neutral

Barion Plus 230V

Visual efect:

Components:

- motor,
- winders,
- radio receiver (integrated),
- limit stop (integrated),

are in the main profile and are invisible from the outside.

Barion Plus 230V – power supply

Ceiling	Wall
2 cm to the center of blinds of the left or the right edge.	<p>The options of supply cable:</p> <ol style="list-style-type: none">1) throughout a hole in the flexible end cap2) throughout a drilled hole in the back of cassette, minimum 2 cm from the lateral edge.

Barion Plus 230V





Classic venetian blinds

Barion

Barion



Barion

Main characteristics:

- width: 60mm,
- height: 50 mm,
- colors: white,
silver,
bronze,
beige,
black.

Barion

Operating limitations :

- Min width **0,40m.**
- Max width **3,00m.**
- Max height **3,00m.**

Barion

Installation to the:

- wall
- Ceiling

by universal mount.

Dimensions

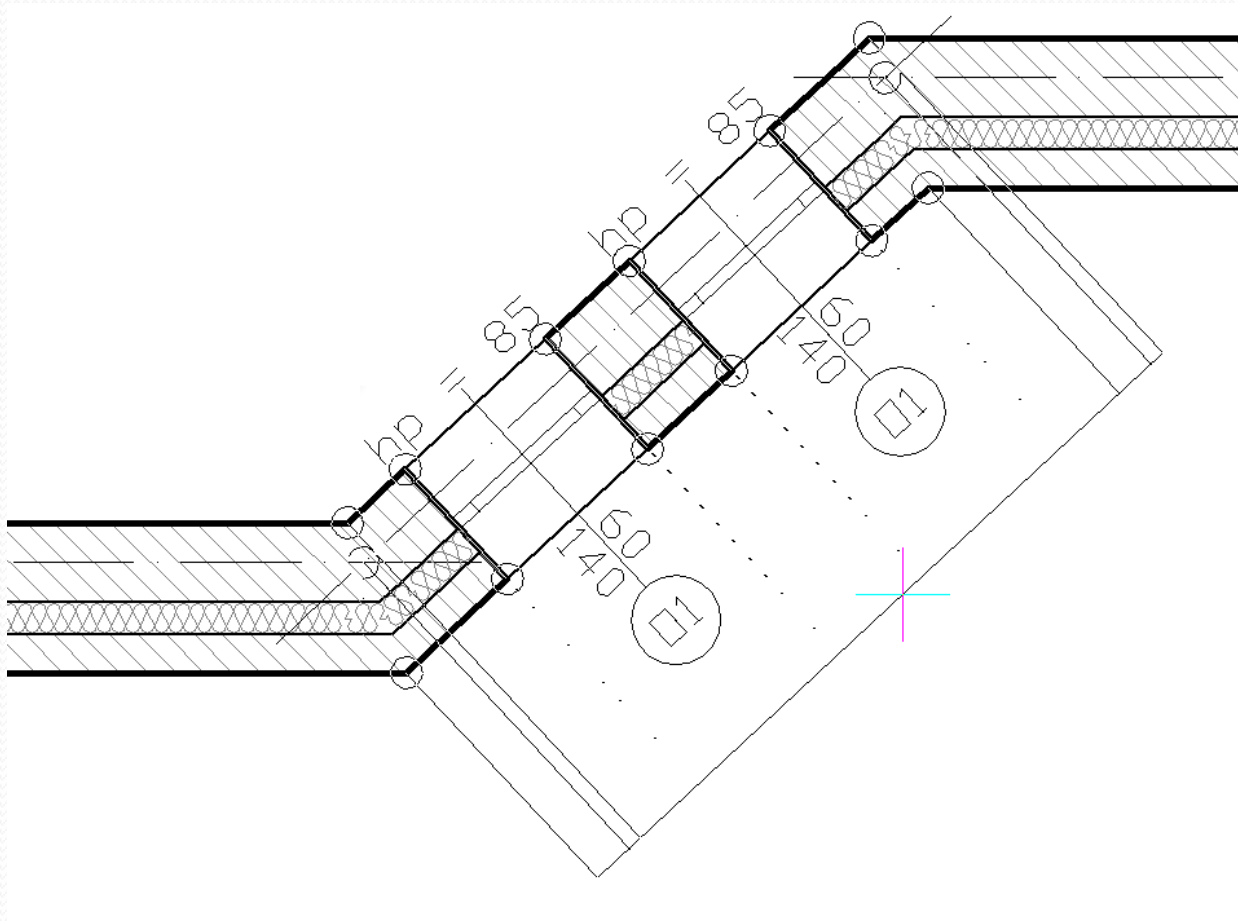

Dimensions

In order please specify:

- the model,
- the width and height,
- the cassette and blind color,
- the side side of wire,
- the control type,
- the installation type (wall/ceiling),
- optional masking profile (straight/overlap)
- optional additional comments.

Dimensions

The width of blinds should be increased by approx. 5-10 cm for each side over a width of window bay.

Is possible to make blinds comprised in a bay. The final width of blinds is the width of bay reduced by approx. 1 cm on each side.

Height is defined from upper edge of cassette (ceiling) to bottom edge of a profile.

Final height after lifting

Blinds model	Final height from the top edge of the cassette to the lower weight profile (after lifting)
Wooden, bamboo rope-ladder	80 mm/meter + 80 mm
Wooden, bamboo belt-ladder	100 mm/meter + 80 mm
Aluminum rope-ladder	50 mm/meter + 80 mm
Aluminum belt-ladder	65 mm/meter + 80 mm

Installation



Installation

- 1) Mark the position of the brackets.
- 2) Drill holes.
- 3) Attach the bracket to the right place at the ceiling / on the wall.
- 4) Fasten the blind.
- 5) Regulate (motor PA) or set (motor RTS) limit stopper.